



# WIRELESS REMOTE CONTROLLER

# OPERATION MANUAL

Thank you very much for purchasing our product.  
Before using your unit, please read this manual carefully and keep it for future reference.



- The outline figure on cover is for reference only, which may differ from what you purchased.
- Make sure to read chapter PRECAUTIONS before you operate the air conditioner.
- This manual is available for model RM02A/BGE-A and RM02A/BGE(T)-A.
- RM02A/BGE-A and RM02A/BGE(T)-A can be applicable for cool & heat type air conditioners.



## CONTENTS

|   |  |    |
|---|--|----|
| 1 | Safety precautions.....                      | 1  |
| 2 | Model and specification.....                 | 2  |
| 3 | Buttons and their functions.....             | 2  |
| 4 | Names of indicators and their functions..... | 4  |
| 5 | Operation instructions.....                  | 5  |
|   | Install and replace batteries.....           | 5  |
|   | Auto operation.....                          | 6  |
|   | Dry / fan / cool / heat Operation.....       | 6  |
|   | Other Functions Operation.....               | 7  |
|   | Timer operation.....                         | 10 |
| 6 | Precautions.....                             | 11 |



# I. Safety Precautions

The following contents are stated on the product and the operation manual, including usage, precautions against personal harm and property loss, and the methods of using the product correctly and safely. After fully understanding the following contents (identifiers and icons), read the text body and observe the following rules.

## ■ Identifier description

| Identifier   | Meaning   |
|--|---|
|  Warning  | Means improper handling may lead to personal death or severe injury.  |
|  Caution  | Means improper handling may lead to personal injury or property loss. |
| <p>[Note]: 1. "Harm" means injury, burn and electric shock which need long-term treatment but need no hospitalization.</p> <p>2. "Property loss" means loss of properties and materials.</p> |   |

## ■ Icon description

| Icon  | Meaning  |
|---|--|
|    | It indicates forbidding. The forbidden subject-matter is indicated in the icon or by images or characters aside.                 |
|  | It indicates compulsory implementation. The compulsory subject-matter is indicated in the icon or by images or characters aside. |

|  |                       |  |
|--|-----------------------|--|
| <br>Warning | Delegate installation | Please entrust the distributor or professionals to install the unit. The installers must have the relevant know-how. Improper installation performed by the user without permission may cause fire, electric, shock, personal injury or water leakage. |
|--|-----------------------|--|

|  |        |  |
|--|--------|--|
| <br>Usage Warning | Forbid | Do not spray flammable aerosol to the wire controller directly. Otherwise, fire may occur.                 |
|  | Forbid | Do not operate with wet hands or let water enter the wire controller. Otherwise, electric shock may occur. |

## 2. Model And Specification

|                                       |                                      |
|---------------------------------------|--------------------------------------|
| Model                                 | RM02A/BGE-A RM02A/BGE(T)-A           |
| Rated voltage                         | 3.0V (2 pieces of LR03 7# batteries) |
| Min voltage for sending signal of CPU | 2.0V                                 |
| Effective receiving distance          | 8m (Where is 3.0V,that will be 11m)  |
| Operation condition                   | -5~60°C                              |

## 3. Buttons And Their Functions

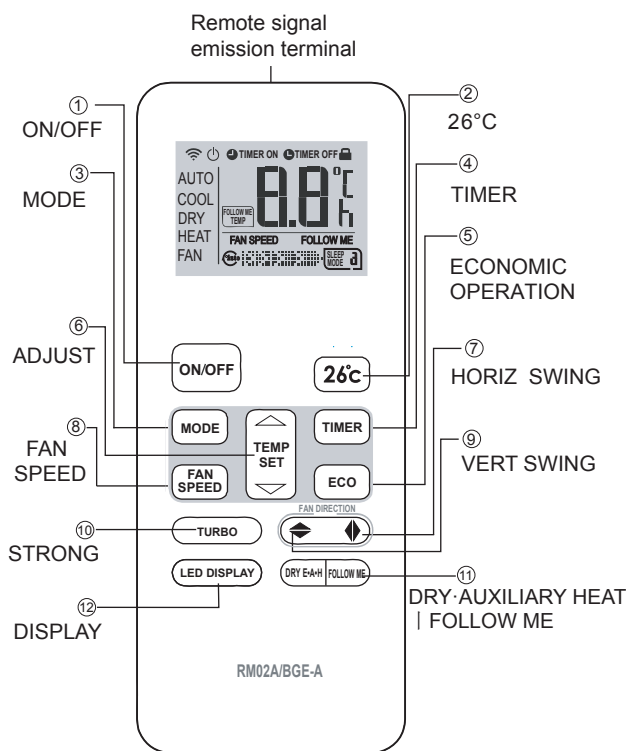
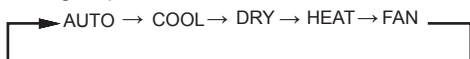

Fig.3-1

- ① ON/OFF: For turning on or turning off the air conditioner.
- ② 26°C: Press this button, can operate the cool mode with the setting temperature 26°C.
- ③ MODE: Once pressing, running mode will be selected in the following sequence:



④ TIMER:

Under the OFF state, press this button, TIMER ON are lighted. continue to press TIMER button, the time will increase by 0.5 hour. When the set time exceeds 10 hours, pressing TIMER button will increase the time by 1 hour. Adjust the TIMER ON to be "0:00" then can cancel the TIMER ON.

Under the ON state, press this button, TIMER OFF are lighted. and continue to press TIMER button, the time will increase by 0.5 hour. When the set time exceeds 10 hours, pressing TIMER button will increase the time by 1 hour. Adjust the TIMER OFF to be "0:00" then can cancel the TIMER OFF.

- ⑤ ECO: Activate or turn off economic operation mode.
- ⑥ ADJUST  $\nabla$  : Decrease the set temp. Keeping pressing will decrease the temp with 1°C per 0.5s.

ADJUST  $\triangle$  : Increase the set temp. Keeping pressing will increase the temp with 1°C per 0.5s.

- ⑦ HORIZ SWING: Activate or turn off wind horizontal swing function. (Only available when remote controller is used with corresponding unit.)
- ⑧ FAN SPEED:

Fan speed will be selected in following sequence once pressing this button: (Under the DRY and AUTO mode (except for the auto heat recycling mode), the fan speed will be fixed and can not be adjusted. Under the auto heat recycling mode, the fan speed will be automatically and can be adjusted.)

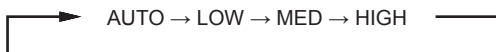

- ⑨ VERT SWING: Activate or turn off wind vertical swing function. Under the power off state, this button will not work. (Only available when remote controller is used with corresponding unit.)

⑩ STRONG:

Press this button, set the air conditioner to operate as strong mode, and the frequency will be raised, press again will cancel this mode. (Only available when remote controller is used with corresponding unit.)

⑪ DRY·AUXILIARY HEAT | FOLLOW ME:

Press the left of the button when it is operating the dry cleaning function, will close the dry cleaning function; press the right of the button when it is operating follow me function, will close the follow me function. (Only available when remote controller is used with corresponding unit.)

⑫ DISPLAY:

When the air conditioner is on the ON state, press this button, can close (open) the modules display, press again will open (close) the display. (Only available when remote controller is used with corresponding unit.)

## 4. Names Of Indicators And Their Functions

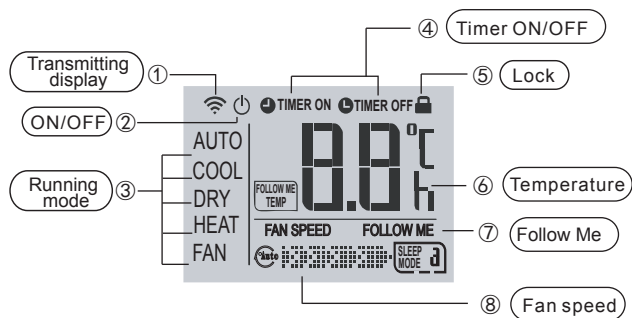

Fig.4-1

- ① Transmitting display: The icon will flash once when the signal is sent by remote controller.
- ② ON/OFF: Icon is displayed when the remote controller is turned on, or vice versa.
- ③ Running mode: Press MODE to display current running mode. AUTO, COOL, DRY, HEAT and FAN can be selected.



④ Timing ON/OFF :

When adjusting timing ON state or only the timing ON function has been set, the “Timing ON” will be displayed; when adjusting timing OFF state or only the timing OFF function has been set, the “Timing OFF” will be displayed.

⑤ Lock :

Press MODE and TIMER button for 5s simultaneously, lock icon will be displayed; Press buttons again, the icon disappears.

⑥ Temperature :

Display the set temperature. Adjust temperature via “ , ”. No display in this area if the unit is on FAN mode.

⑦ Follow Me:

Under the cool, heat, auto mode operation state, press the right of “DRY E•A•H | FOLLOW ME” button, the follow me icon will be displayed, and press again the icon will be disappeared.

⑧ Fan speed :

Press FAN SPEED to display the current wind speed. AUTO, LOW, MED and HIGH can be selected. The default state is high fan speed for the unit without medium fan speed.



## CAUTION

---

All the above icons are listed for instruction, and the relative items will be displayed when operation. And all the icons will be displayed when the remote controller is electrified for the first time or reset.

---

## 5. Operation Instructions

### 5.1 Install and Replace Batteries

1. Install 2 pieces of 7# alkaline batteries.
2. Slide the cover to install batteries and make sure to place them in right pole.

## 5.2 Auto Operation (Normal)

### AUTO operation

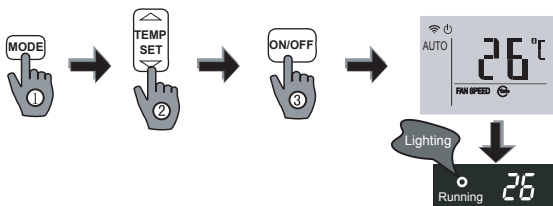

Fig.5-1

1. Press MODE to select AUTO.
2. Adjust temp via  $\triangle$  and  $\nabla$ . Generally the range is 17°C~30°C .
3. Press ON/OFF and running indicator light on indoor unit is lightened. Air conditioner will work on AUTO mode and fan speed is AUTO, the display screen on remote controller will display "AUTO", then the fan speed is adjustable. And press ON/OFF again, the air conditioner will be stopped.

## 5.3 Dry/fan/cool/heat Operation

### DRY/FAN/COOL/HEAT OPERATION

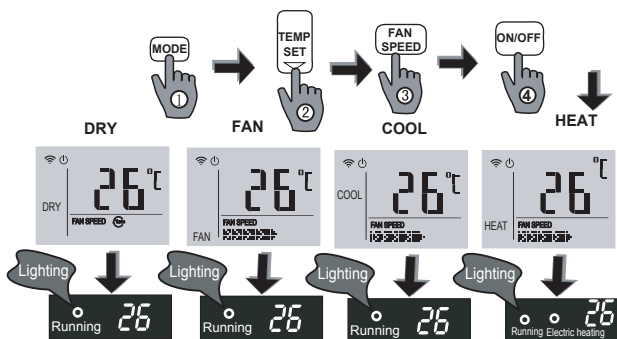

Fig.5-2

1. Press MODE to select COOL, DRY, HEAT or FAN.
2. Adjust temp via  $\triangle$  and  $\nabla$ . Generally the range is 17°C~30°C .
3. Press FAN SPEED to select AUTO, LOW, MED or HIGH.
4. Press ON/OFF and running indicator light on indoor unit is lightened. Air conditioner will work on the set mode. Stop operation via ON/OFF.





## CAUTION

“FAN” operation can not set the temperature, when select this operation only can do 1,3,4 steps.

“DRY” operation can not set the fan speed, when select this operation only can do 1,2,4 steps.

## 5.4 Other Functions Operation

### Dry function

#### ● Function instruction

This air conditioner has dry function, close the unit under the cool and dry mode, the air conditioner will operate the dry function automatically, then the icon will be lightened. For cool-only model, the air conditioner will Low operate with fan mode for 10 mins and then close the unit automatically.

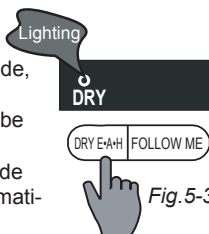

Fig.5-3

#### ● Stop operation

If you want to stop the dry function, can presss the left of “DRY E•A•H | FOLLOW ME” under the function is operating, then can stop the function, and the icon will be off.

### Follow me function

#### ● Function instruction

This air conditioner has follow me function, when this function is operated, the remote controller will detect the temperature near the remote controller and compare with the temperature you set automatically, and control the operation of the air conditioner according to the contrastive result, and make the temperature near the remote controller reaches the setting temperature. This function is valid only under COOL, HEAT, AUTO mode and the unit has follow me function.

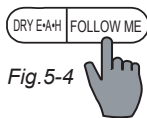

Fig.5-4

- The remote controller can not be placed near the heat source or low temperatue source, otherwise will affect its temperature gathering precision and then affect the follow me function.

### Strong operation function

- Function instruction

When operating cooling, press the "TURBO" button and operate the strong cooling operation, at the same time raise the frequency, press again will close the strong operation.

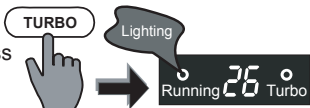

Fig.5-5

- This function is invalid under operating sleep function.

### Energy-saving function

- Function instruction

When operating COOL/AUTO, press the "ECO" button, and operate power save function; press again will cancel the function.

- Under the DRY/FAN mode, this function is invalid.
- Under power save state, press "MODE", "ON/OFF" or "FAN" button will cancel this function.

### Display function

- Function instruction

For avoiding the display light of the indoor unit will affect customer's rest, this unit has special display function. When the air conditioner is operated, press the "DISPLAY" button, then can close (open) the module display, press again can open (close) the display.

### 26°C green function

- Function instruction

Press "26°C" on the remote controller can operate the cooling operation mode with the setting temperature of 26°C.



Fig.5-6

### Lock function

- Function instruction

Press the "MODE" and "TIMER" button at the same time and last over 5s, then can operate locking the remote controller.

In locked state, all the buttons are ineffective.

Press the "MODE" and "TIMER" button again at the same time and last over 2s, then can close the locking.

## Auto heat recycling mode function

### ● Function instruction

$\Delta T$ : Temperature difference, means the different temperature between the indoor temperature ( $T_f$ ) detected by the remote controller and the remote controller setting temperature ( $T_s$ ). (the default difference is  $3^{\circ}\text{C}$ , the difference range is  $1\sim 4^{\circ}\text{C}$ )

### $\Delta T$ instruction



 press  $\triangle$  and  $\nabla$  buttons for 5S simultaneously, then enter  $\Delta T$  setting state.

  $\Delta T$  setting state

 press  $\triangle$  or  $\nabla$  button adjust  $\Delta T$  you want

 press ON/OFF button confirm and exit the setting

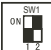
### SW1 definition

|   |                          |
|---|--------------------------|
|  | Auto heat recycling Mode |
|  | Auto Mode (Normal)       |

### Example:

$\Delta T$  is  $1^{\circ}\text{C}$ ,  $T_s$  is  $25^{\circ}\text{C}$ .

when  $T_f - T_s \geq +\Delta T$ , it will operate COOL mode, the fan speed will be operated according to the setting fan speed.

when  $T_f - T_s \leq -\Delta T$ , it will operate HEAT mode, the fan speed will be operated according to the setting fan speed.

### Note:

This function operations only available when the indoor unit is in the heat recycling three-pipe system.

When the remote controller selects the auto heat recycling-mode, the remote controller position must be placed at the signal receiving range of the air conditioner.

When the remote controller detects changes of the mode (cool to heat, or heat to cool), it will send the changes to air conditioner.

One beep of air conditioner changed mode signals is giving out.



## CAUTION

5.4 Other functions operations only available when the indoor unit has corresponding functions.

## 5.5 Timer Operation

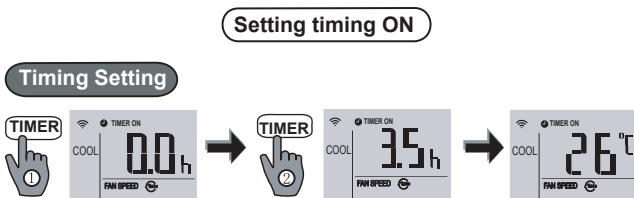

Fig.5-7

1. Under the remote controller is OFF, press the “TIMER” button, then the remote controller will display the timing ON icon and number display area will show up last timing ON time, and will display icon “h”. The remote controller enters to the timing ON adjusting state.
2. (Continue) Press “TIMER” button, then can adjust the timing ON time to what you want.
3. After adjustment, the remote controller transmit the timing ON signal, and after 5s the icon “h” will be disappeared, and the number display area will back to display temperature, then finish the timing ON setting.

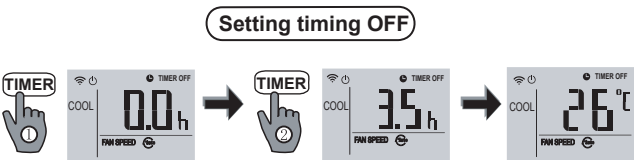

Fig.5-8

1. Under the remote controller is ON, press the “TIMER” button, then the remote controller will display the timing OFF icon and number display area will show up last timing OFF time, and will display icon “h”. The remote controller enters to the timing OFF adjusting state.
2. (Continue) Press “TIMER” button, then can adjust the timing OFF time to what you want.
3. After adjustment, the remote controller transmit the timing OFF signal, and after 5s the icon “h” will be disappeared, and the number display area will back to display temperature, then finish the timing OFF setting.



---

Importado por: **INTENSITY AIR, S. A. DE C. V.**

RFC: IAI-100609-SRA.

Río Amacuzac #1125, Col. Valle Ote., CP. 66269

San Pedro Garza García, Nuevo León, México

**Note:** Product specifications change from time to time as product improvements and developments are released and may vary from those in this document.